

VarioTel
Nr. 28 241.0001



GB **Operating Instructions**
Please keep the instructions in a safe place.



CE 0682

Safety instructions GB- 2

Explanation of buttons GB- 3

General information GB- 4

Designated use GB- 4

Note GB- 5

Wall holder installation GB- 5

Explanation of functions GB- 6

 Transmission control light GB- 6

 Group control GB- 6

 Select button GB- 6

Programming radio channel settings GB- 7

 Programming transmitter/channel GB- 7

 Programming additional transmitters GB- 7

Intermediate position for roller shutter/awning/
venetian blind GB- 9

 Programming intermediate position GB- 9

 Programming ventilation/reverse position GB- 9

 Adjustment to intermediate position GB-10

 Adjustment to ventilation/reverse position GB-10

 Deleting intermediate position GB-10

 Deleting ventilation/reverse position GB-10

Deleting radio channel settings GB-11

 Deleting individual transmitters GB-11

 Deleting all transmitters GB-11

Technical data GB-12

Battery replacement GB-12

Cleaning GB-12

Troubleshooting GB-12

General declaration of conformity GB-12



Warning!

Important safety instructions!

The following instructions must be observed at all times.

- For use in dry rooms only.
- Use unmodified **elero** original parts only.
- Keep persons away from the systems guide track.
- Keep children away from controls.
- Always comply with national stipulations.
- Always dispose of used batteries properly. Always replace batteries with identical type (LR 03; AAA).
- If the system is controlled by one or more transmitters, the system guide track must be visible during operation.
- The equipment contains small parts that could be swallowed.

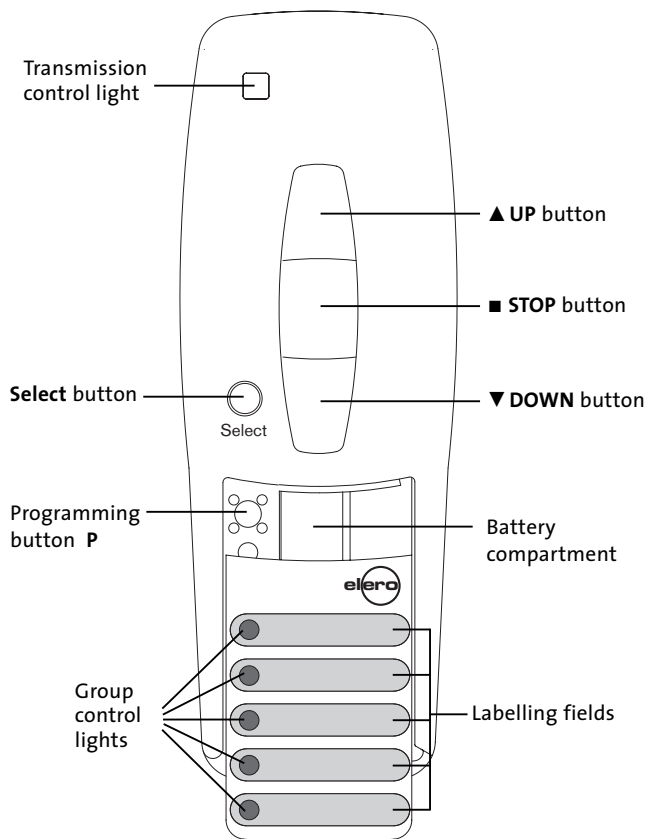

General information

The VarioTel handheld transmitter can be used to operate up to five receivers individually or altogether.

The VarioTel device is characterised by its user-friendly operation.

Designated use

The VarioTel may be used to operate roller shutters/sun protection systems **only**.

- Please note that radio-controlled systems may **not** be used in areas with a high risk of interference (e.g. hospitals, airports).
- The remote control is intended solely for use with equipment and systems in which malfunctions in the handheld transmitter or receiver would not pose any risk to persons, animals or property or which contain safety devices to eliminate such risks.
- The operator is not protected from interference from other telecommunications systems and terminal equipment (e.g. even from radio-controlled systems which are properly operated in the same frequency range).
- Radio receivers may only be used in combination with equipment and systems stipulated in manufacturers' specifications.

Note: Radio stations transmitting in the same frequency range may cause reception interference.

Please note that the operating range of the radio signal is limited by legislation as well as by the product design

Wall holder installation

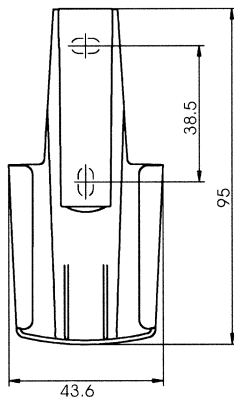

- Before installing the wall holder, always ensure that the transmitter and receiver are in proper working order.
- Mount the holder onto the wall using the two raw plugs and screws provided.

Transmission control light

The transmission control light is illuminated when a radio signal is being transmitted.

The transmission control light will flash during transmission if battery power is low.

The transmission power or radio operating range will decrease as battery power decreases. If the transmission control light does not light up when the buttons are pressed, the batteries must be replaced.

Group control

Group control refers to the operation of one or more receivers at the same time. The group selected is controlled via a control command.

The VarioTel is used to operate groups via five radio channels.

Select button

The **Select** button may be used to select and programme up to 5 channels. The LED lights for the different channels light up to indicate when a given channel is being used.

An additional channel is reserved for central command control. This is allocated automatically. When the central command is active, all five LEDs light up.

Note: The inlay card beneath the transparent cover can be used to make a note of the groups which have been programmed.

Programming transmitter/channel

Prerequisite: The receiver must be installed.

1. With pre-installed electric receivers, the fuse must be disconnected and reconnected after a few seconds. The receiver will remain in programming mode for approximately 5 minutes.
2. Position yourself in front of the roller shutter/awning/venetian blind with the remote control in your hand.
3. Open the front cover of the device and press the transmitter programming button **P briefly**. The shutter/awning/venetian blind will start to move up and down. This will happen for approximately 2 minutes.
4. Select the desired channel using the **Select** button.
5. To define the keyboard layout, press the **UP** button on the transmitter as soon as the shutter/awning/venetian blind begins to move upwards (after approx. 1 second). The shutter/awning/venetian blind will come to a halt briefly. **As soon as** the shutter/awning/venetian blind begins to move again, press the **DOWN** button on the handheld transmitter. The shutter/awning/blind will come to a stop. The transmitter or this channel has been successfully programmed.

Programming additional transmitters

To programme additional transmitters in one receiver, please proceed as follows:

1. Press the **UP, DOWN** and programming button **P** on a transmitter that has already been programmed in the receiver until the LED goes out.
2. To define the keyboard layout, press the **UP** button on the handheld transmitter **as soon as** the shutter/awning/venetian blind begins to move upwards (after approx. 1 second). The shutter/awning/blind will come to a halt briefly. As soon as the shutter/awning/venetian blind begins to move again, press the **DOWN** button on the handheld transmitter. The shutter/awning/venetian blind will come to a stop. The transmitter or this channel has been successfully programmed.

Note: If more than one receiver is connected to the same supply lead, all of these will be in programming mode simultaneously. The shutters/awnings/venetian blinds will begin to move up and down "at random". The longer you take to carry out the programming, the larger the offset will be.



Individual channels can now be assigned to the given receiver.

To stop the brief up and down movements, press the **STOP** button on one of the pre-programmed handheld transmitters briefly.

Channel assignment/modification can now be carried out without you having to disconnect individual receivers.

Select the desired channel using the **Select** button.

If the shutter/awning/venetianblind moves in the wrong direction, the transmitter must be deleted and re-programmed.

	Roller shutter 	Awning 	Venetian blind 
Pos ▽	Intermediate position	Intermediate position	Intermediate position
Pos △	Ventilation position	Canopy tension	Reverse position

Programming Pos ▽

Prerequisite: The transmitter has been programmed and the end limit positions have been set. The roller shutter/awning/venetian blind is in the upper end limit position.

1. Adjust the roller shutter/awning/venetian blind into the desired position using the **DOWN** button.

Note: Keep the **DOWN** button pressed until the desired position is reached.

2. When the roller shutter/awning/venetian blind has reached the desired position, press the **STOP** button **in addition**. The curtain/canopy/blind will come to a stop. The intermediate position has been successfully programmed.

Programming Pos △

Prerequisite: The transmitter has been programmed and the end limit positions have been set. The roller shutter/awning/venetian blind is in the upper end limit position.

1. Move the roller shutter/awning/venetian blind in the **UP** direction using the handheld transmitter until the ventilation slits are open or the reverse position has been reached.

Note: Keep the **UP** button pressed until the desired position is reached.

2. When the roller shutter/awning/venetian blind has reached the desired position, press the **STOP** button **in addition**. The roller shutter/awning/venetian blind will come to a stop. The ventilation/reverse position has been successfully programmed.

Adjustment to Pos ▽

Prerequisite: The transmitter has been programmed.

1. Press the **UP** button twice **in quick succession**.
2. The drive will adjust the roller shutter/awning/venetian blind into the stored intermediate position. If no intermediate position is stored, the roller shutter/awning/venetian blind is automatically adjusted into the lower limit position.

Adjustment to Pos △ (roller shutter, awning)

Prerequisite: The transmitter has been programmed.

1. Press the **UP** button twice **in quick succession**.
2. The roller shutter/awning is adjusted into the stored ventilation position. If no ventilation position is stored, the roller shutter/awning is automatically adjusted into the upper limit position.

Adjustment to Pos △ (venetian blind)

Prerequisite: The transmitter has been programmed.

1. Press the **UP** button twice **in quick succession**.
2. The venetian blind is adjusted into the stored reverse position. If no reverse position is stored, the venetian blind is automatically adjusted into the lower limit position.

Deleting Pos ▽

1. Press the following buttons **simultaneously**:
 - **DOWN** button
 - **STOP** button
2. Keep these two buttons pressed until the LED goes out briefly.

Deleting Pos △

1. Press the following buttons **simultaneously**:
 - **UP** button
 - **STOP** button
2. Keep these two buttons pressed until the LED goes out briefly.

Deleting individual transmitters

Disconnect the fuse – and reconnect after a few seconds.

1. Open the front cover on the device and press the following buttons **simultaneously**:
 - Programming button **P**
 - **STOP** button
2. Keep these two buttons pressed until the LED goes out briefly.

Deleting all transmitters

Disconnect the fuse – and reconnect after a few seconds.

1. Open the front cover on the device and press the following buttons **simultaneously**:
 - Programming button **P**
 - **UP** button
 - **STOP** button
 - **DOWN** button
2. Keep all of these buttons pressed until the LED flashes 3 times.

Technical data

Operating voltage	3 V DC
Battery requirements	2 x LR 03 (AAA)
System of protection	IP 20
Permissible ambient temperature	-10 to +55 °C
Operating frequency	433,92 MHz AM
Dimensions in mm	L 121 x W 43 x H 23

The maximum radio range is 25 m indoors and 350 m outdoors.

Battery replacement

1. Open the battery compartment.
2. Remove the batteries.
3. Insert the new batteries **properly**.

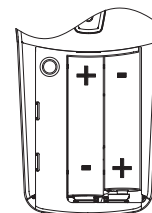

Cleaning

Clean the device with a damp cloth only.

Do not use a cleansing agent as doing so may damage the plastic.

Troubleshooting

Problem	Cause	Remedy
Drive is not functioning. Transmission control light is not illuminated.	1. Batteries are empty. 2. Batteries are inserted incorrectly.	1. Replace batteries. 2. Remove batteries and re-insert properly.
Drive is not functioning. Transmission control light is illuminated.	1. Receiver is not within radio operating range. 2. Transmitter is not programmed in receiver.	1. Move receiver closer to ensure it is within operating range. 2. Programme transmitter.
Transmission control light is flashing.	Battery power is low.	Replace batteries.
Selected drive is not functioning.	Wrong group has been selected.	Select the correct group.
Drive moves in wrong direction.	The directions have been set incorrectly.	Delete transmitter and re-programme correctly.

General declaration of conformity:

The company elero GmbH hereby declares that the VarioTel handheld transmitter complies with the basic requirements and other relevant regulations of the EC Directive 1999/5/EG.